



LB
ALUMINIUM
BERHAD
198501006093 (138535-V)



SLD/PS03MR

A medium range sliding door suite that is not only designed to perform but also packed with innovative features.



Performance Range

- Medium duty.

Typical Technical Features

Inner Frame Depth	- 40 mm
Inner Frame Width	- 86 mm
Nominal Wall Thickness	- 1.5 mm
Outer Frames	- 1, 2 and Multiple Tracks
Outer Frame Depth	- Variable
Corner Joints	- Mitre joints with brackets



Other Features

Flexible Outer Frame Design

Least Profiles Members

Multipoint Locking

Double Glazing Option

European Accessories

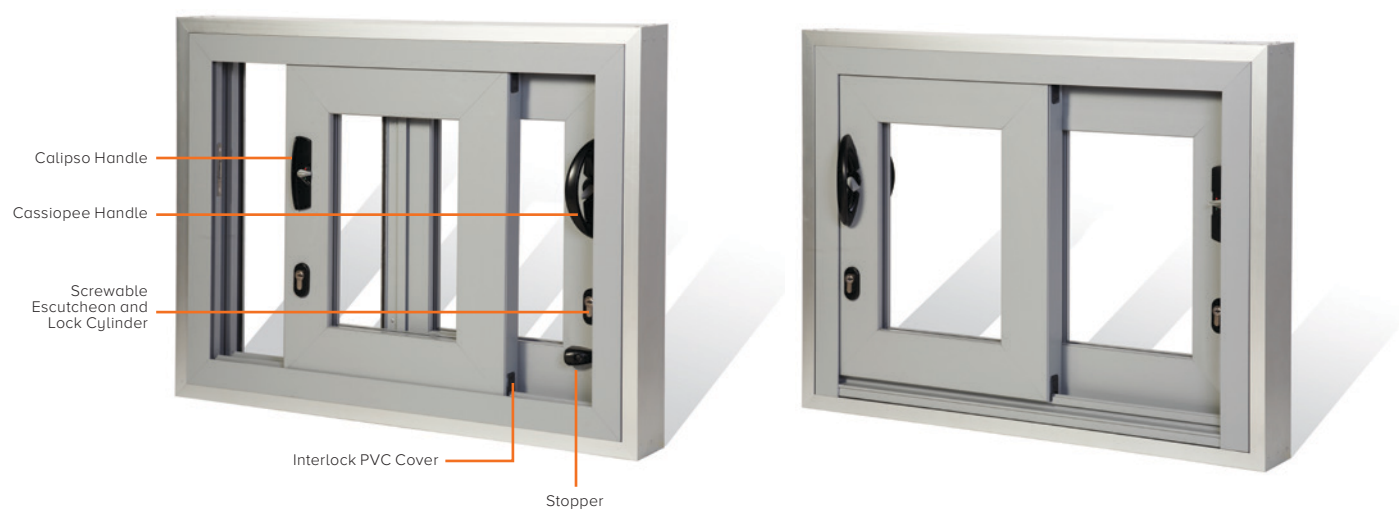

Typical Assembly Details

Typical Elevations - 2 and 4 Sliding Panels

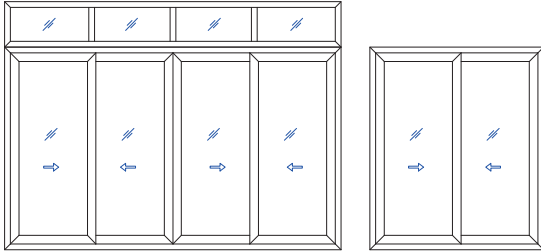

Vertical Sectional View

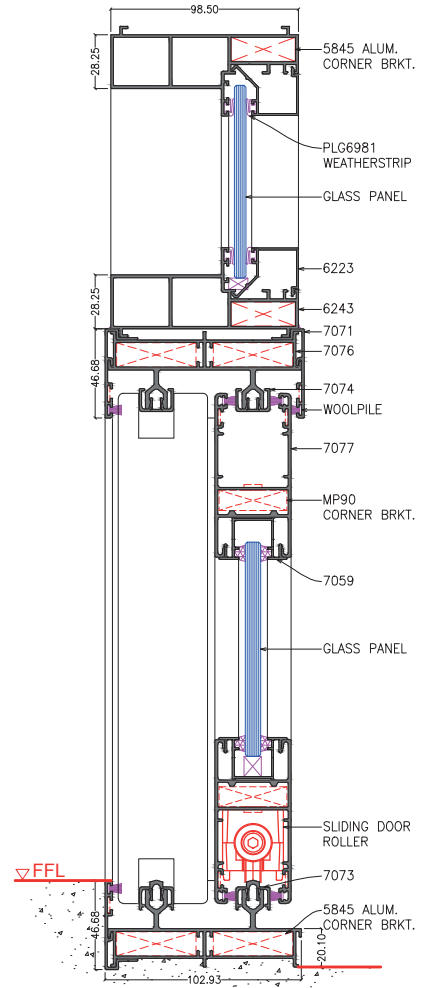

Horizontal Sectional View

Fixed Glass Panels

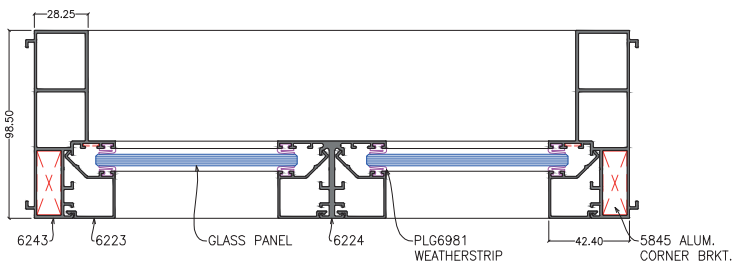

2 Track 2 Sliding Panels

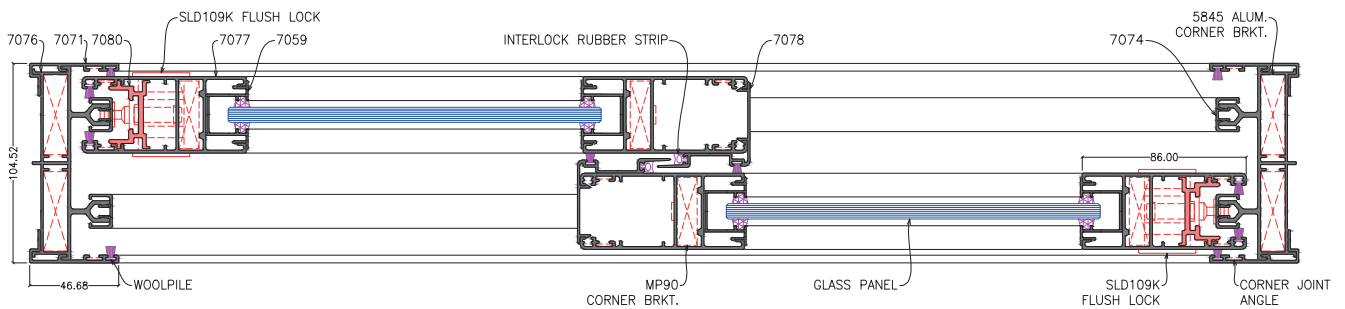

2 Track 4 Sliding Panels

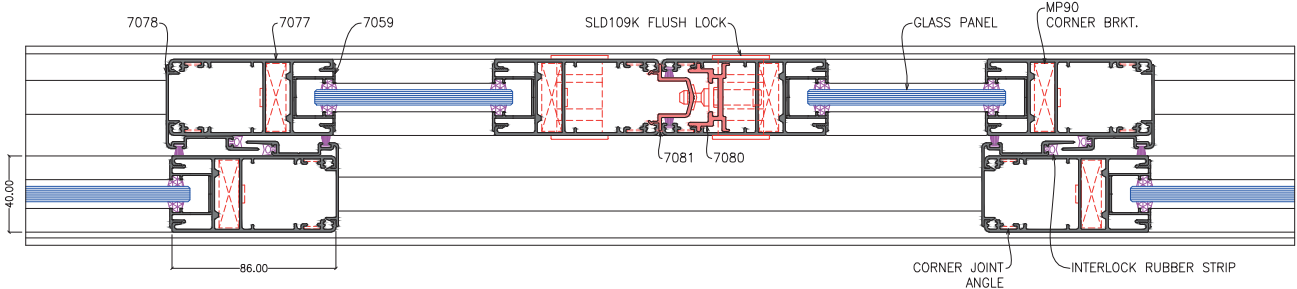

Typical Assembly Details

Typical Elevations - 3 and 6 Sliding Panels

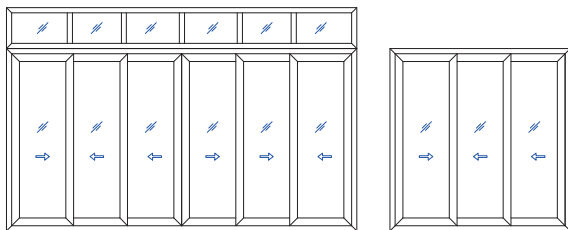

Vertical Sectional View

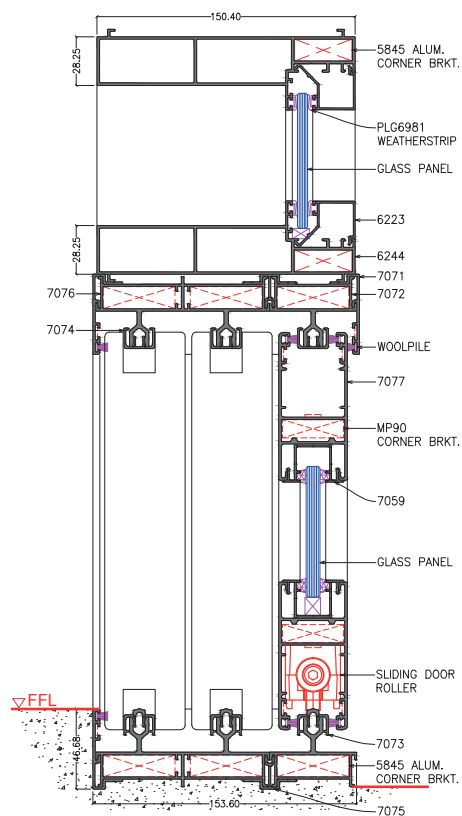

Horizontal Sectional View

Fixed Glass Panels

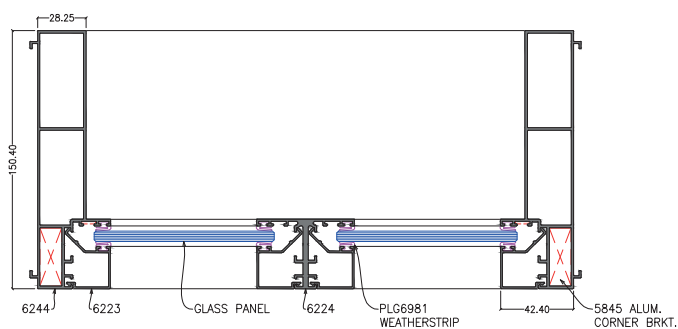

3 Track 3 Sliding Panels (Single Glazed)

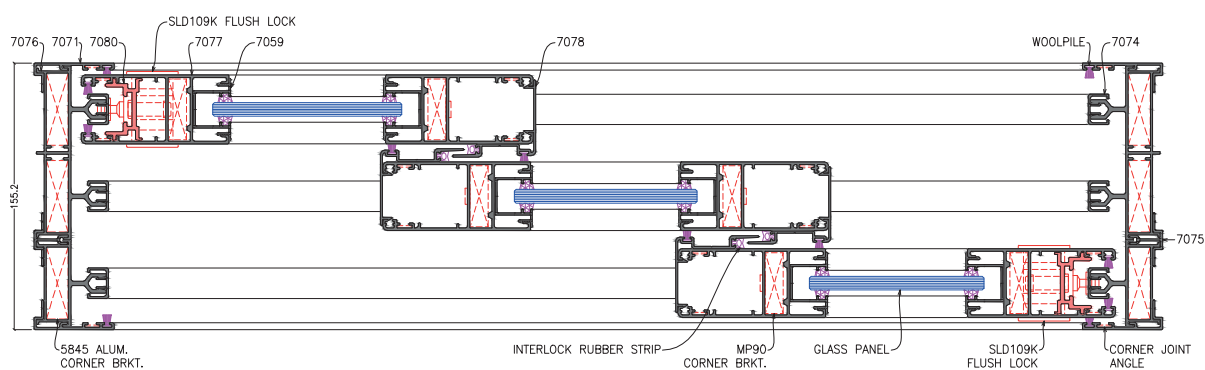

3 Track 6 Sliding Panels (Single Glazed)

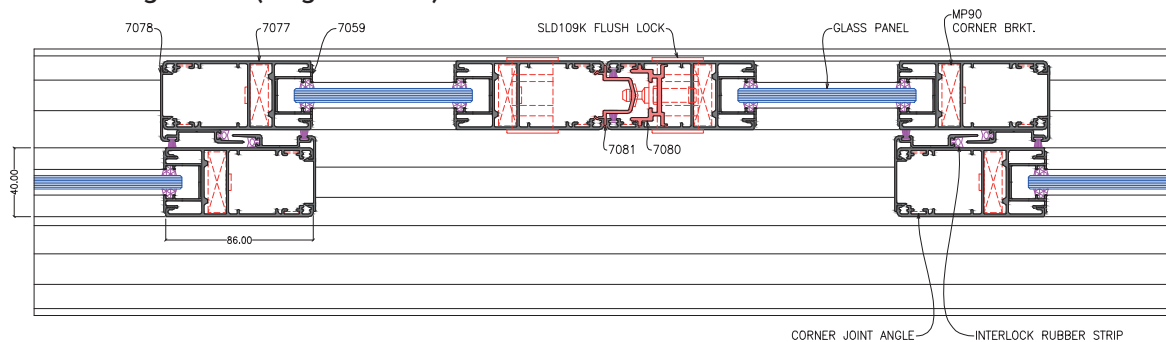

Wind Load Chart

Mullion Section No. : 7077(x2) & 7078(x2)

Aluminium Alloy : 6063 - T5

Moment of Inertia Ixx : 31 cm⁴

Mod. of Elasticity : 69 x 10⁹ n/m²

Deflection Limit : Span/175 up to max. 20 mm

Perm. Bend. Stress : 1.25 x 67 Mpa
(within slenderness limit)

Nature of Anchor : Simply Supported at Both Ends

Typical Configuration of Sliding Door:

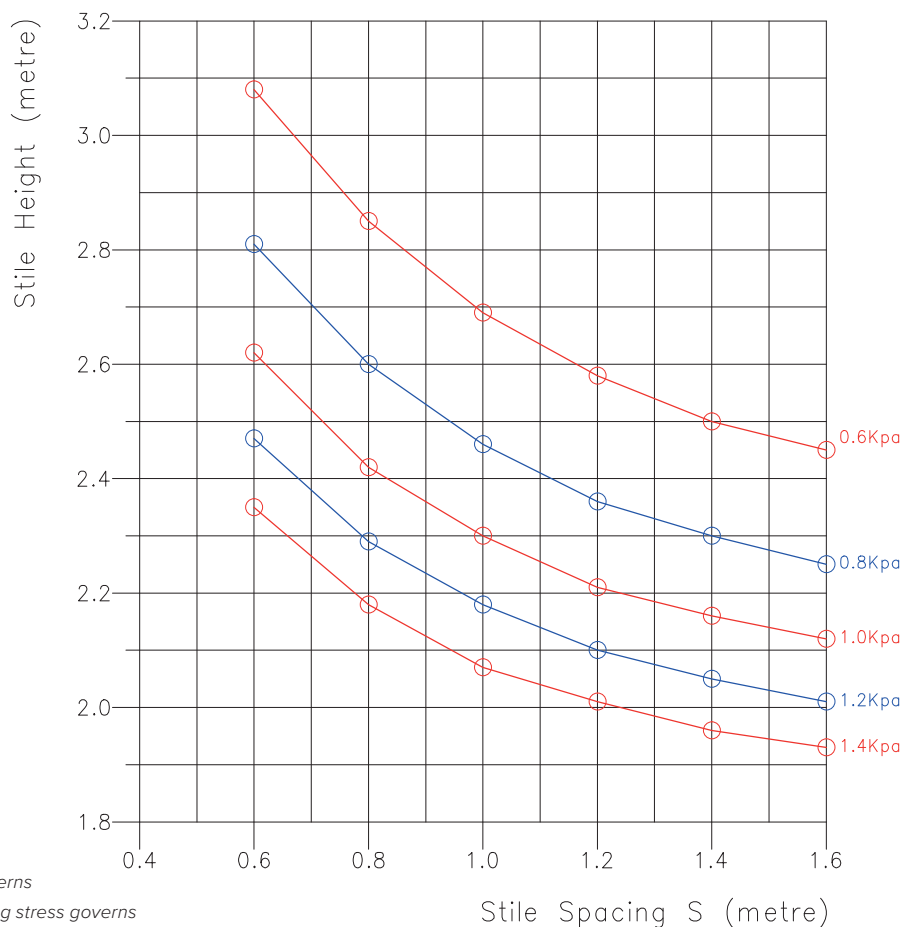
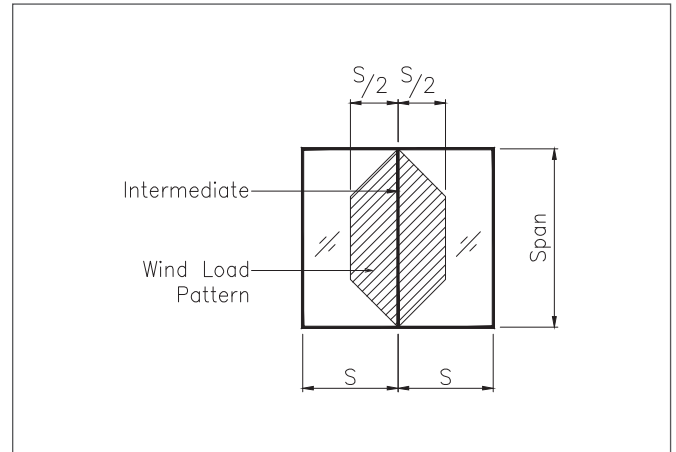
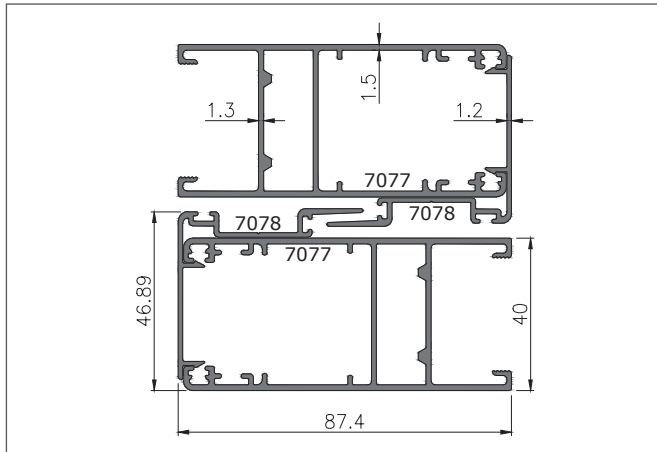

Legend:

○ Deflection limit governs

◇ Permissible bending stress governs

Note: This wind load chart is solely for reference only.

Wind Load Chart

Mullion Section No. : 7077(x2) & 7081

Aluminium Alloy : 6063 - T5

Moment of Inertia Ixx : 27.1 cm⁴

Mod. of Elasticity : 69 x 10⁹ n/m²

Deflection Limit : Span/175 up to max. 20 mm

Perm. Bend. Stress : 1.25 x 67 Mpa
(within slenderness limit)

Nature of Anchor : Simply Supported at Both Ends

Typical Configuration of Sliding Door:

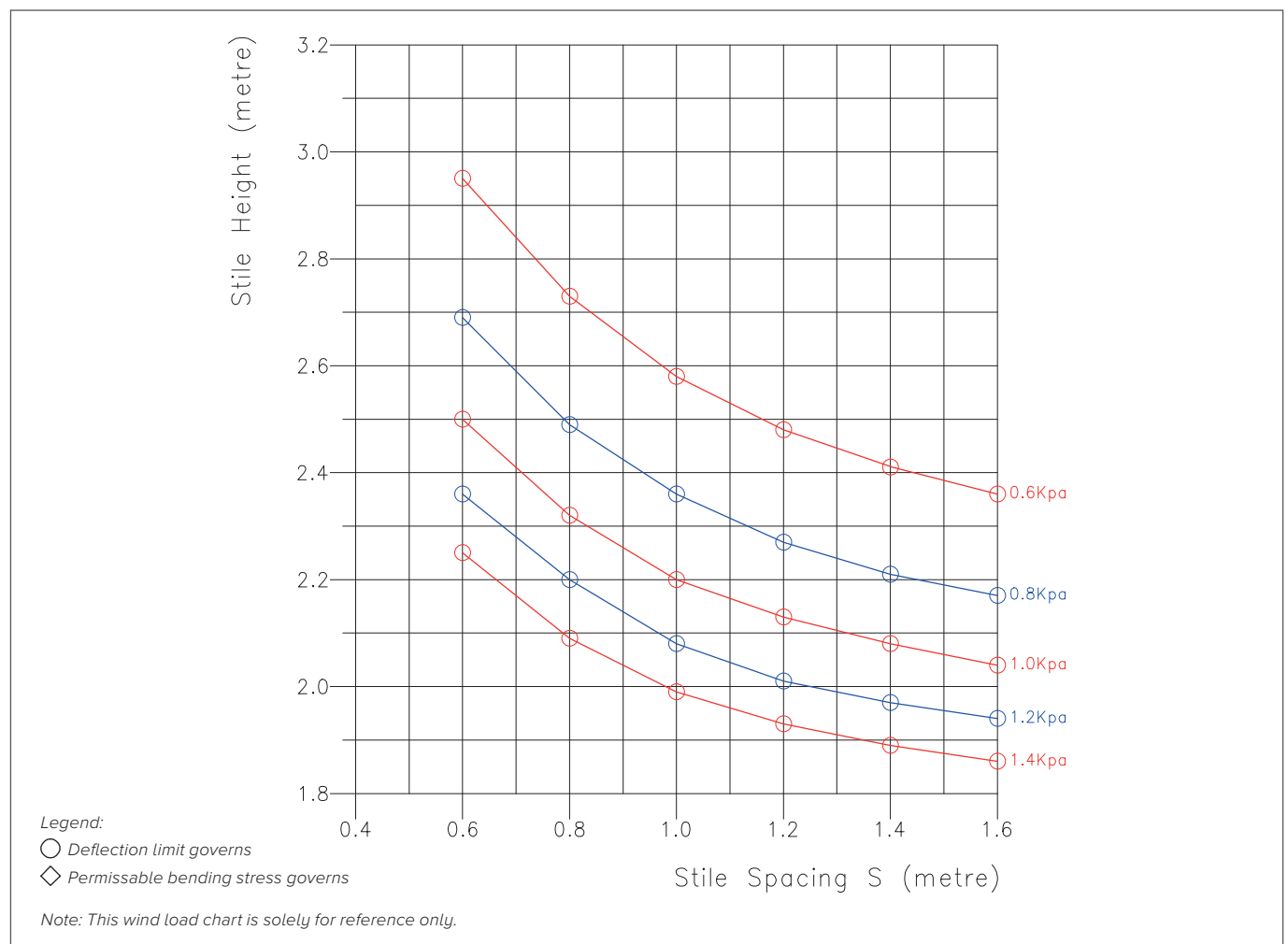
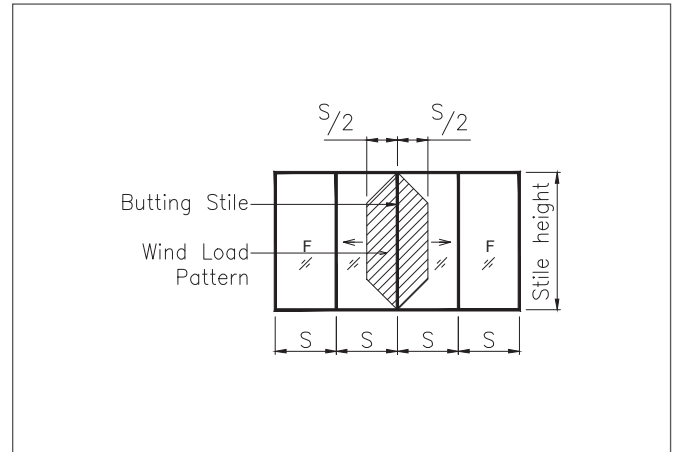
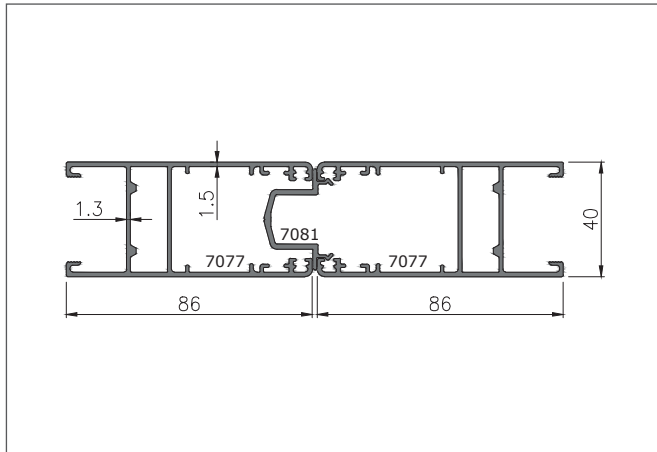

Sectional Details

Outer Upright, Outer Frame & Outer Frame Joiner

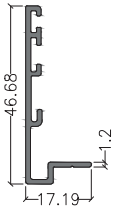

7071

0.299 kg/m "LW"
172.75 mm "AP"

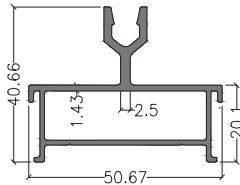

7072

0.703 kg/m "LW"
236.28 mm "AP"

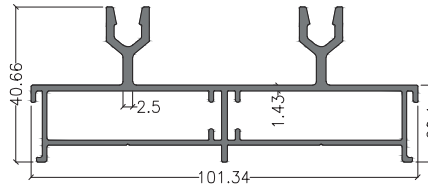

7076

1.391 kg/m "LW"
416.48 mm "AP"

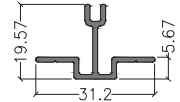

7075

0.220 kg/m "LW"
131.40 mm "AP"

Inner Frame, Interlock Attachment & Capping

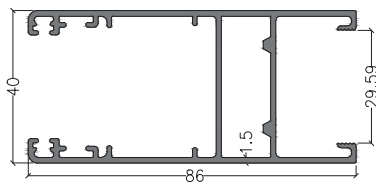

7077

1.211 kg/m "LW"
504.90 mm "AP"
Ixx : 12.9 cm⁴
Iyy : 28.2 cm⁴

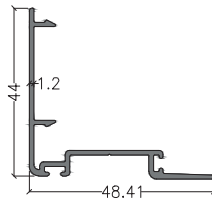

7078 (For 7077)

0.398 kg/m "LW"
239.24 mm "AP"

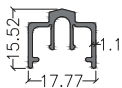

7073 (Bottom Track)

0.187 kg/m "LW"
118.12 mm "AP"



7074 (Top & Side)

0.161 kg/m "LW"
109.36 mm "AP"

Corner Brackets

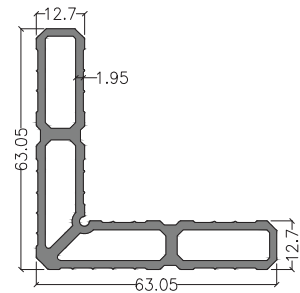

5845

1.543 kg/m "LW"
258.77 mm "AP"

Glazing Channel, Mid-nose Joint & Attachment For Lock

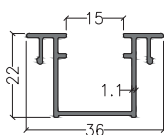

7059

0.290 kg/m "LW"
199.56 mm "AP"

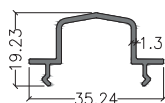

7054

0.231 kg/m "LW"
136.98 mm "AP"

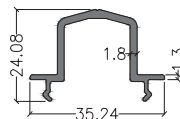

7081

0.338 kg/m "LW"
153.17 mm "AP"

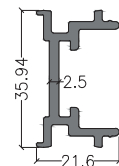

7080

0.528 kg/m "LW"
178.30 mm "AP"

ALBE DOOR PERFORMANCE SLIDING DOOR SLD/PS03MR SERIES

Accessories

Door Locksets



CK84 Double



CK83 Single

Multipoint Flush Lock



SLD109K
with Key
(with Lockbar
& Keeper)

Rollers



NZ03 New Zealand,
AES Roller
(Rating: 80kg)



NZ04 New Zealand,
AES Roller
(Rating: 40kg)



FP005DRA Italy,
FAPIM SPA Roller
(Rating: 70kg)

Stopper



Escutcheon



8645
Screwable
Escutcheon

Support Block



Fixed Panel
Support Block

Interlock Rubber Strip



7055

Corner Joint Angle



SLD/CJC02
(8mm)

Weep Hole Cover



Lock Cylinder

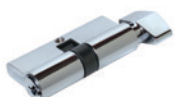

Keeper



Interlock PVC Cover



SLD/IC02

Skider



SLD/SK04

Woolpile



5 x 7
(300 meter/
roll/grey colour)

Corner Brackets



MP90
(Inner)

5845 Alum.
(Outer)



LB
ALUMINIUM
BERHAD
198501006093 (138535-V)

HEAD OFFICE & FACTORY

Lot 11, Jalan Perusahaan 1, Kawasan Perusahaan Beranang,
43700 Beranang, Semenyih, Selangor Darul Ehsan, Malaysia.

Tel: +603-8725 8822 (Gen)

Email: enquiry@lbalum.com.my

Website: www.lbalum.com

Fax: +603-8725 8828 (Gen)

+603-8725 8866 (Export)



MS ISO 9001:2015 Cert. No. QMS 00216

Ver. 05/2020