



LB
ALUMINIUM
BERHAD
138535-V



PCW02-40

An innovative window casement system with unparalleled performance. Available in a broad range of specifications to suit the design requirements for medium to high-end applications.



Performance Range

- Medium duty.

Typical Technical Features

Nominal Wall Thickness	- 1.2 - 1.6 mm
Standard Frame Depth	- 40 mm
Maximum Frame / Mullion Depth	- 100 mm
Glazing Gap	- 10 - 33 mm
Multipoint Locking System	- Available
Sub-frame	- Compatible
Overlapping Inner Frames	- Standard
Butt. Hinges	- Available (Exposed Only)



Accessories Arrangement

Overlapping Option Of Multipoint Locking - Without Center Mullion

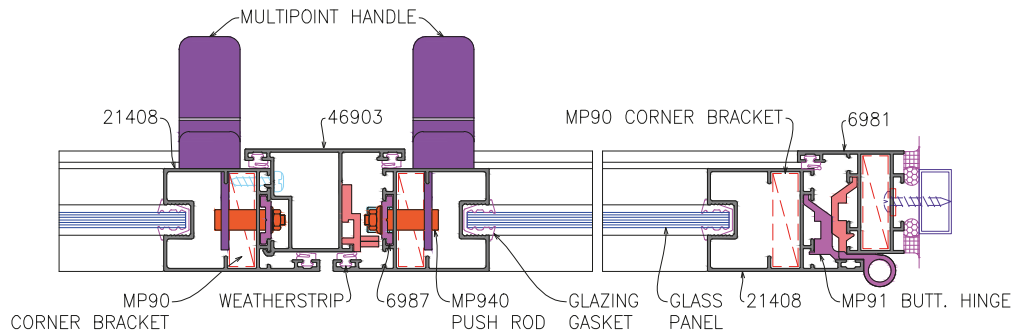

Flush Face Option Of Multipoint Locking - Without Center Mullion

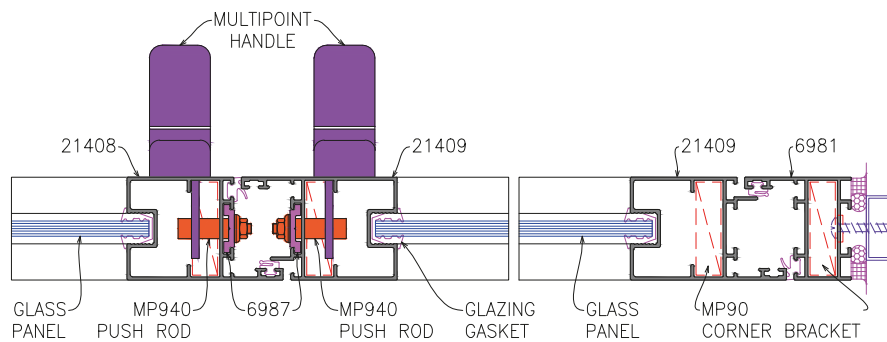

Glass Glazing Options - Inner Frames

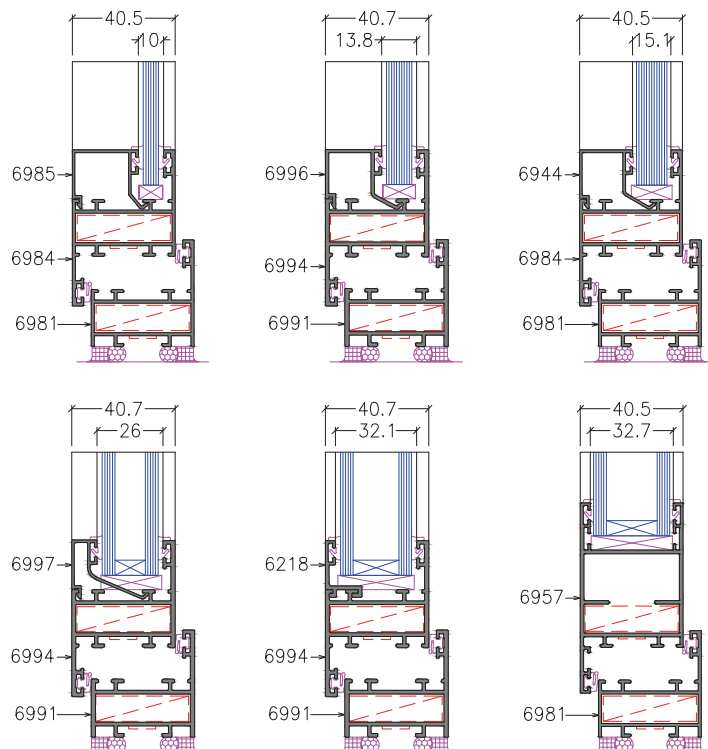

Internal - Glazing Frame

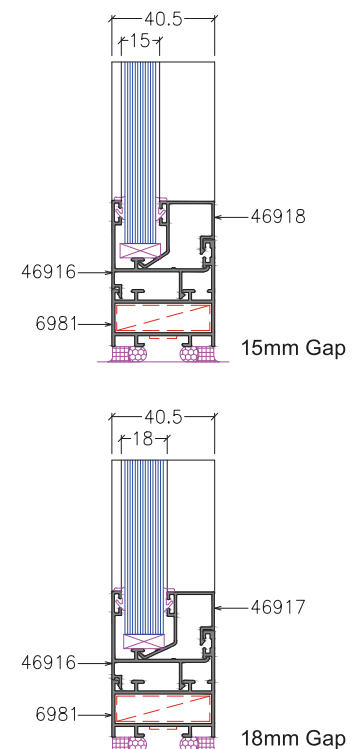

Wind Load Chart

Mullion Section No. : 6982
 Aluminium Alloy : 6063 - T5
 Moment of Inertia Ixx : 8.1 cm⁴
 Mod. of Inertia Zxx : 3.3 cm³

Mod. of Elasticity : 69 x 10⁹ n/m²
 Deflection Limit : Span/175 up to max. 20 mm
 Perm. Bend. Stress : 1.25 x 67 Mpa
 (within slenderness limit)
 Nature of Anchor : Simply Supported at Both Ends

Typical Configuration of Window:

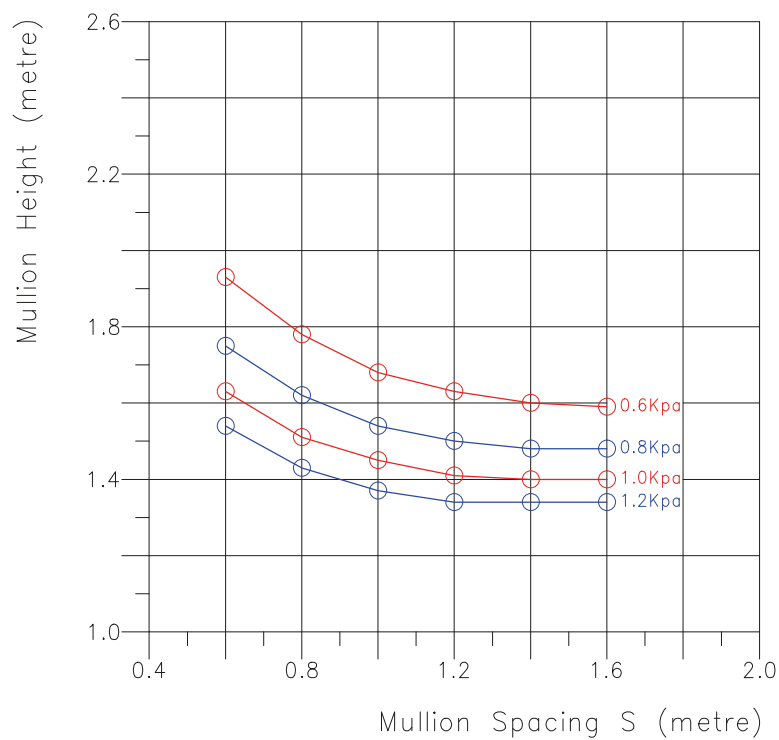
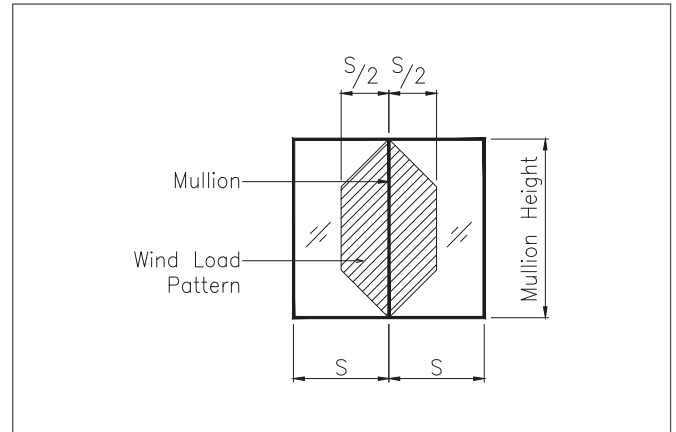
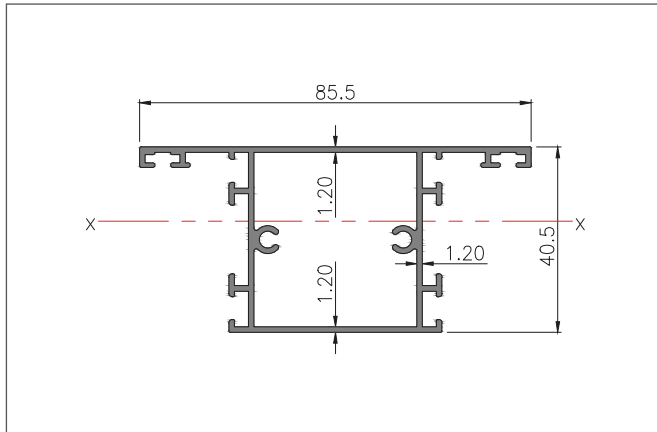

Legend:

○ Deflection limit governs

◇ Permissible bending stress governs

Note: This wind load chart is solely for reference only.

Wind Load Chart

Mullion Section No. : 6993
Aluminium Alloy : 6063 - T5
Moment of Inertia Ixx : 10.3 cm⁴
Mod. of Inertia Zxx : 4.2 cm³

Mod. of Elasticity : 69 x 10⁹ n/m²
Deflection Limit : Span/175 up to max. 20 mm
Perm. Bend. Stress : 1.25 x 67 Mpa
(within slenderness limit)
Nature of Anchor : Simply Supported at Both Ends

Typical Configuration of Window:

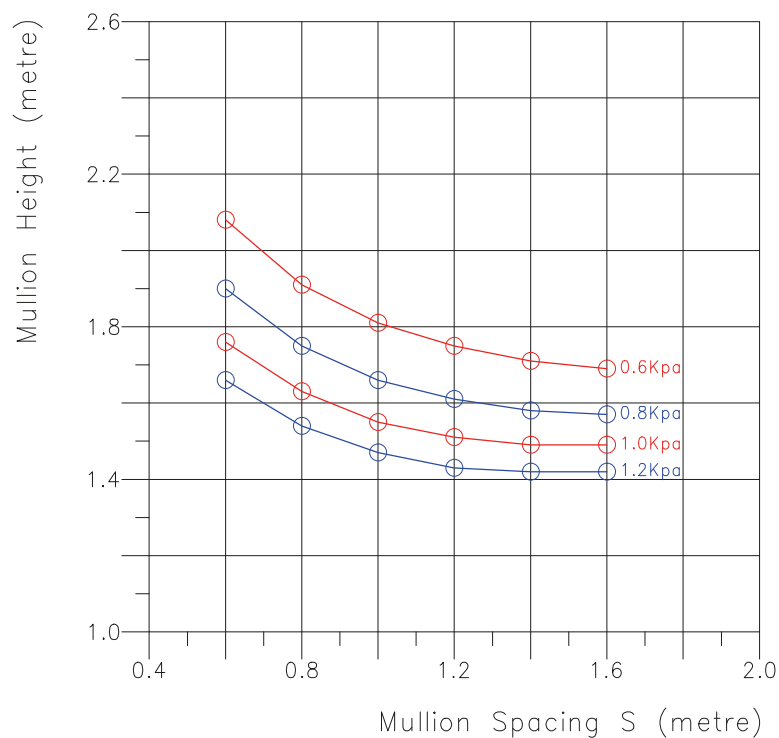
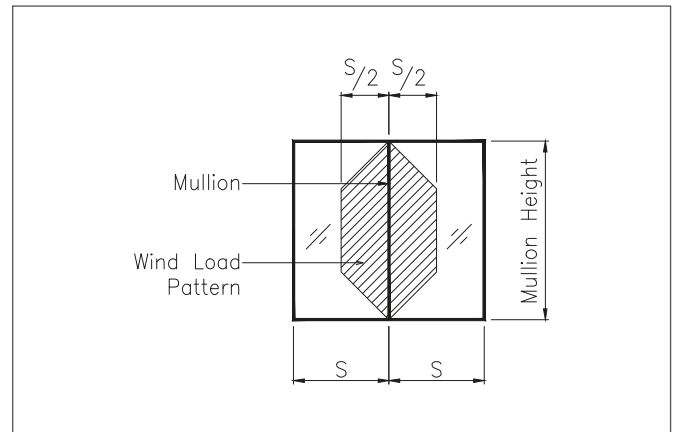
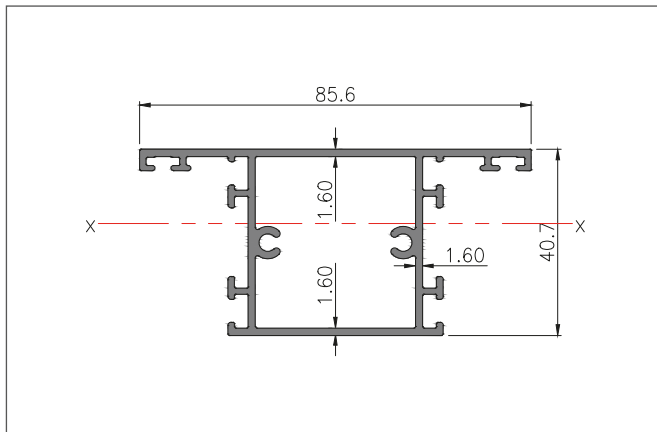

Legend:

○ Deflection limit governs

◇ Permissible bending stress governs

Note: This wind load chart is solely for reference only.

Wind Load Chart

Mullion Section No. : 14296
 Aluminium Alloy : 6063 - T5
 Moment of Inertia Ixx : 30.4 cm⁴
 Mod. of Inertia Zxx : 6.9 cm³

Mod. of Elasticity : 69 x 10⁹ n/m²
 Deflection Limit : Span/175 up to max. 20 mm
 Perm. Bend. Stress : 1.25 x 67 Mpa
 (within slenderness limit)
 Nature of Anchor : Simply Supported at Both Ends

Typical Configuration of Window:

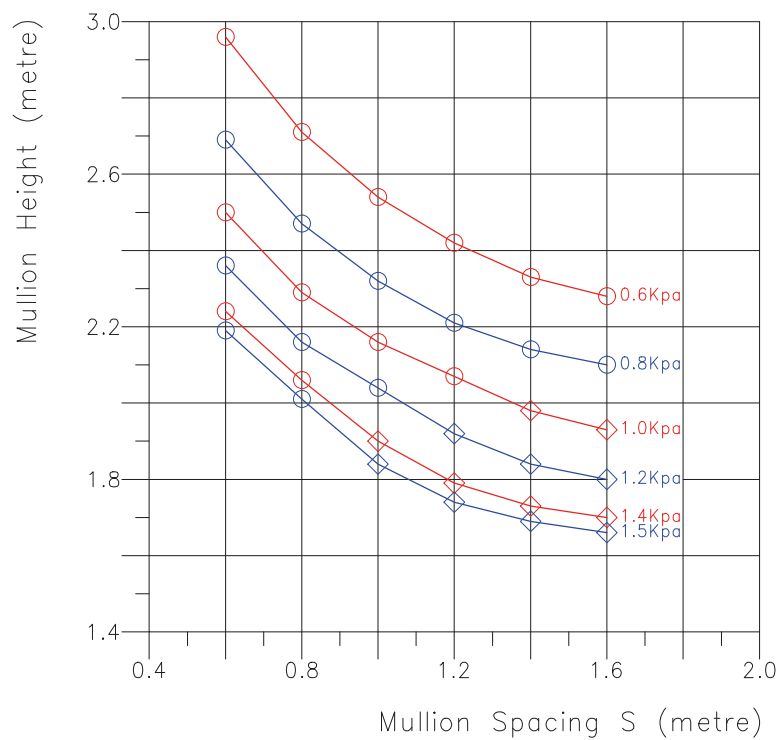
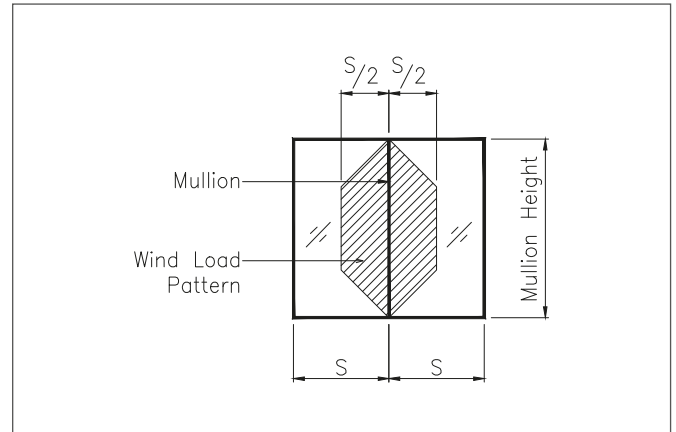
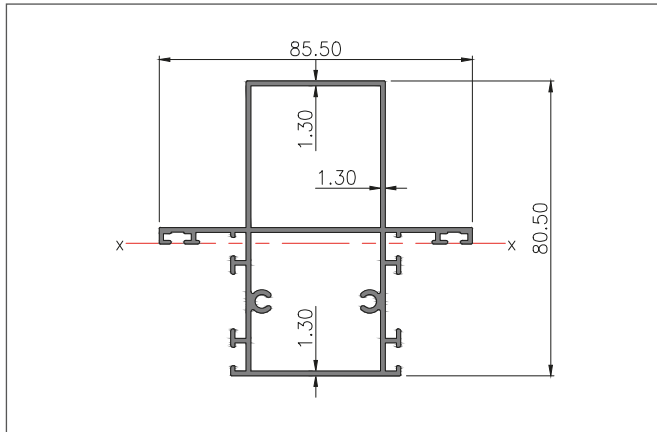

Legend:

○ Deflection limit governs

◇ Permissible bending stress governs

Note: This wind load chart is solely for reference only.

ALBESASH PERFORMANCE CASEMENT WINDOW PCW02-40 SERIES

Wind Load Chart

Mullion Section No. : 6965

Aluminium Alloy : 6063 - T5

Moment of Inertia Ixx : 91 cm⁴

Mod. of Inertia Zxx : 17 cm³

Mod. of Elasticity : 69 x 10⁹ n/m²

Deflection Limit : Span/175 up to max. 20 mm

Perm. Bend. Stress : 1.25 x 67 Mpa
(within slenderness limit)

Nature of Anchor : Simply Supported at Both Ends

Typical Configuration of Window:

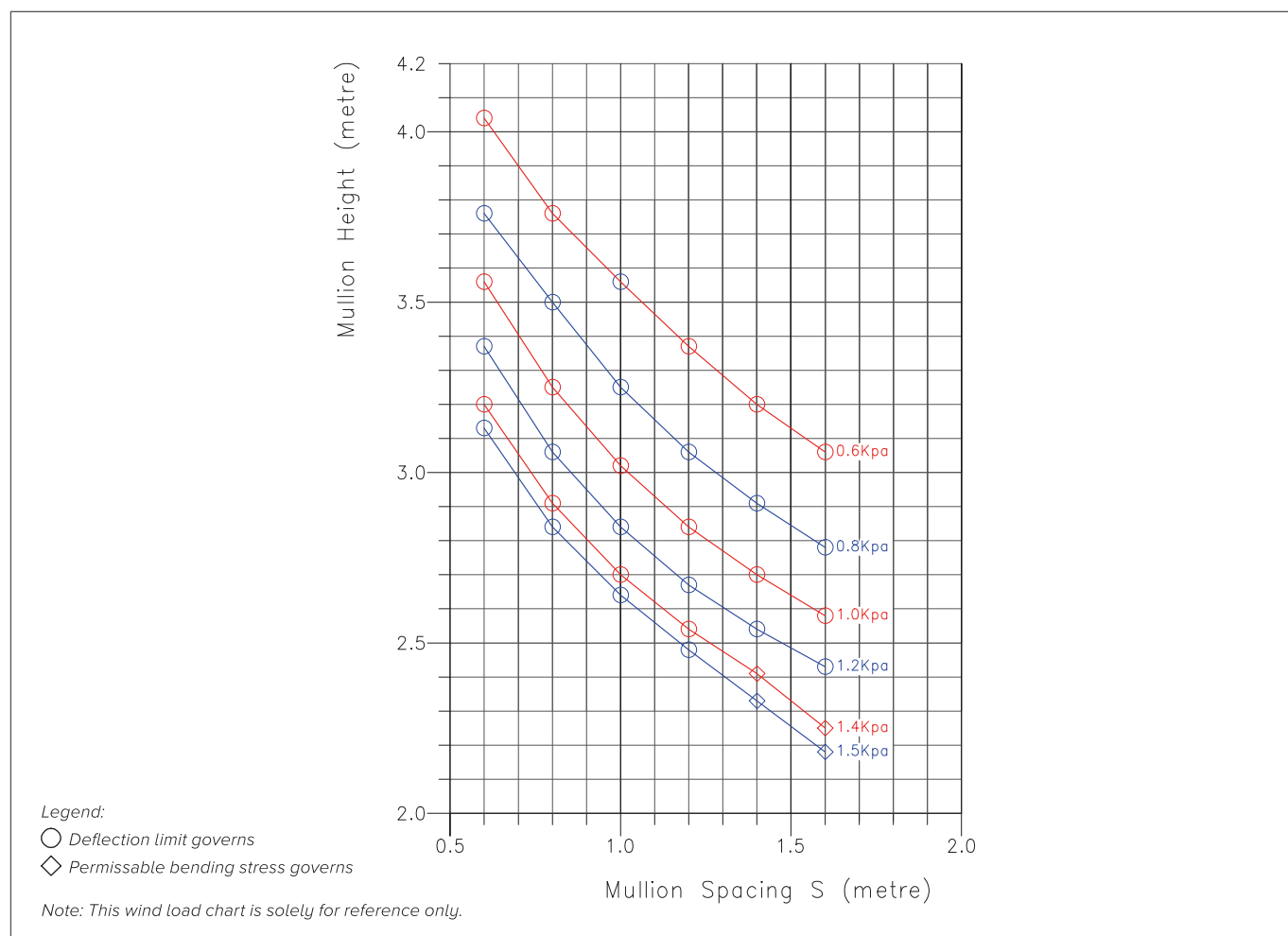
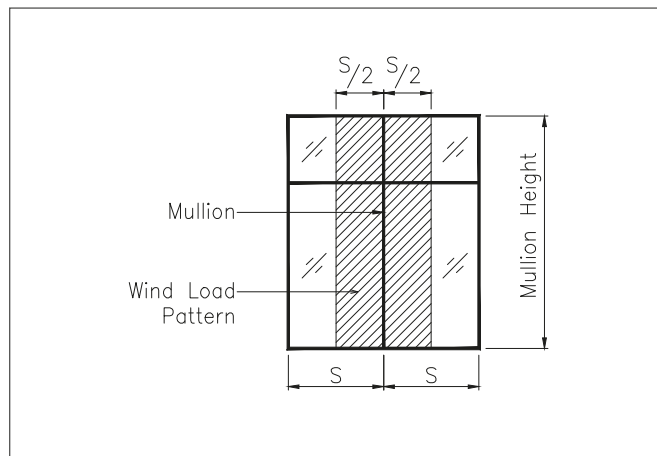
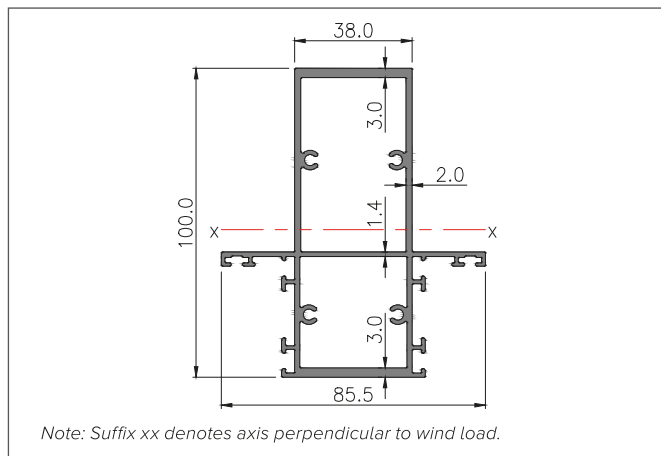

Sectional Details

Outer Frames

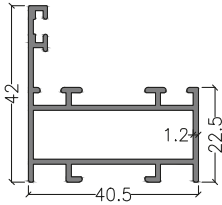

6981

0.601 kg/m "LW"
264.86 mm "AP"

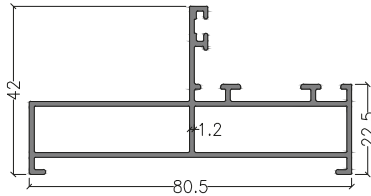

6956

0.875 kg/m "LW"
325.99 mm "AP"

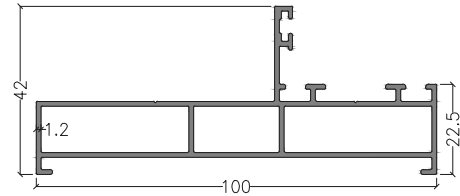

6964

1.039 kg/m "LW"
365.35 mm "AP"

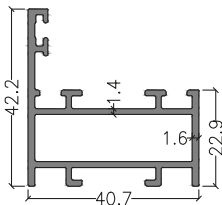

6991

0.724 kg/m "LW"
261.43 mm "AP"

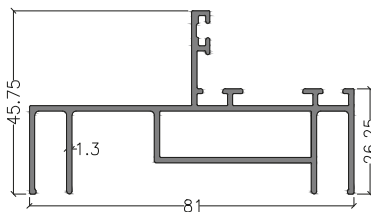

6998

0.958 kg/m "LW"
436.30 mm "AP"

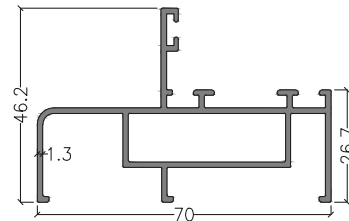

6988

0.884 kg/m "LW"
380.48 mm "AP"

Glazing Beads

10mm Bead

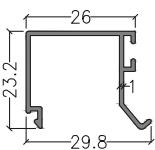

6985

0.231 kg/m "LW"
169.79 mm "AP"

10mm Bead

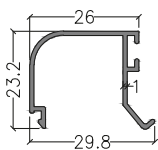

6986

0.233 kg/m "LW"
163.56 mm "AP"

14mm Bead

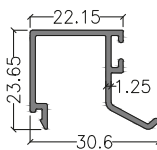

6996

0.286 kg/m "LW"
168.80 mm "AP"

15mm Bead

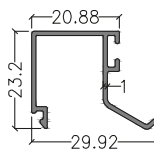

6944

0.228 kg/m "LW"
166.07 mm "AP"

19mm Bead

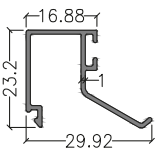

46902

0.224 kg/m "LW"
162.69 mm "AP"

26mm Bead

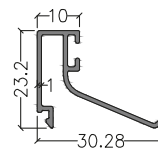

6997

0.219 kg/m "LW"
159.37 mm "AP"

32mm Bead

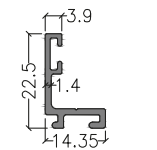

6218

0.179 kg/m "LW"
101.90 mm "AP"

34mm Bead

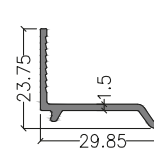

46910

0.213 kg/m "LW"
108.69 mm "AP"

Slide Bars

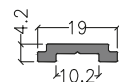

6987

0.140 kg/m "LW"
49.24 mm "AP"
(For Natural Anodised
Finish Only)

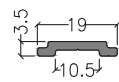

6219

0.117 kg/m "LW"
45.58 mm "AP"
(For Powder Coated
& PVDF Finish Only)

Sectional Details

Intermediate Mullions

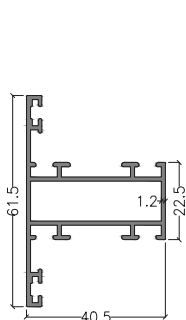

6983

0.722 kg/m "LW"
335.59 mm "AP"
Ixx : 5.2 cm⁴
Iyy : 5.7 cm⁴

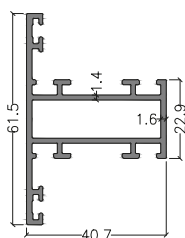

6992

0.865 kg/m "LW"
327.18 mm "AP"
Ixx : 6.1 cm⁴
Iyy : 7.0 cm⁴

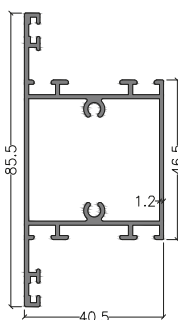

6982

0.965 kg/m "LW"
383.59 mm "AP"
Ixx : 17.4 cm⁴
Iyy : 8.1 cm⁴

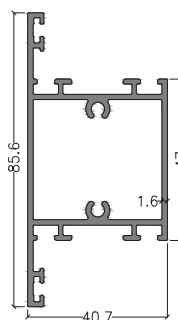

6993

1.211 kg/m "LW"
375.44 mm "AP"
Ixx : 21.0 cm⁴
Iyy : 10.3 cm⁴

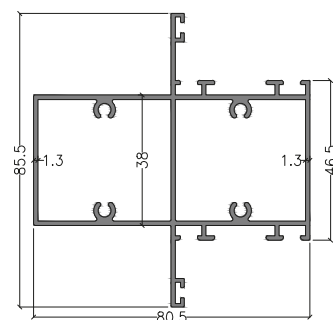

6977

1.495 kg/m "LW"
451.00 mm "AP"
Ixx : 21.5 cm⁴
Iyy : 32.2 cm⁴

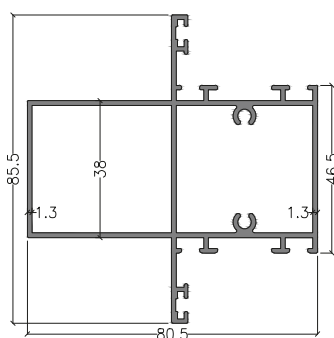

14296

1.427 kg/m "LW"
462.13 mm "AP"
Ixx : 22.0 cm⁴
Iyy : 30.4 cm⁴

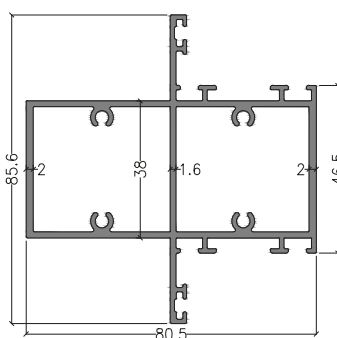

46900

1.829 kg/m "LW"
454.30 mm "AP"
Ixx : 25.3 cm⁴
Iyy : 41.8 cm⁴

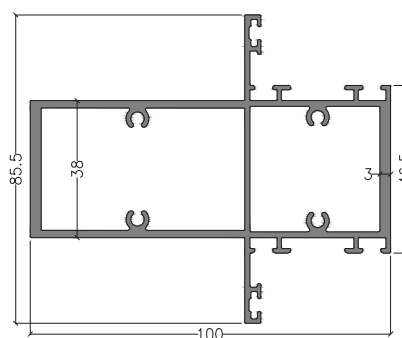

6965

2.277 kg/m "LW"
494.70 mm "AP"
Ixx : 29.0 cm⁴
Iyy : 91.0 cm⁴

T-Joint Bracket

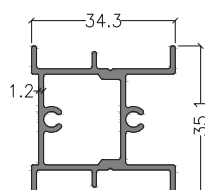

6976

0.553 kg/m "LW"
214.74 mm "AP"

Internal Glazing Frame

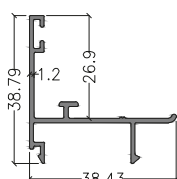

46916

0.333 kg/m "LW"
215.22 mm "AP"

18mm Bead

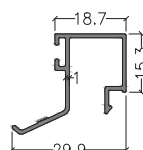

46917

0.235 kg/m "LW"
171.92 mm "AP"

15mm Bead

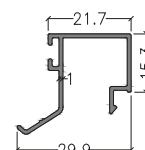

46918

0.236 kg/m "LW"
172.01 mm "AP"

Sectional Details

Inner Frames

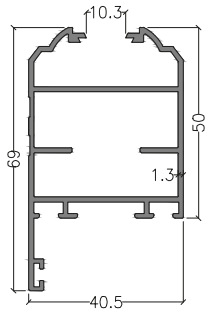

5835

0.972 kg/m "LW"
361.01 mm "AP"

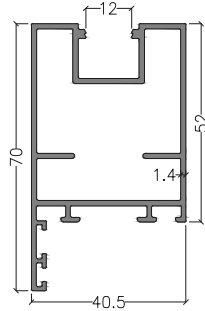

6201

1.037 kg/m "LW"
320.36 mm "AP"

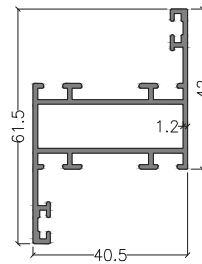

6984

0.722 kg/m "LW"
335.59 mm "AP"

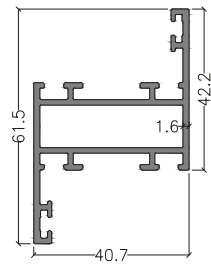

6994

0.864 kg/m "LW"
326.98 mm "AP"

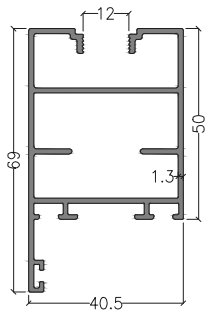

6999

0.973 kg/m "LW"
377.96 mm "AP"

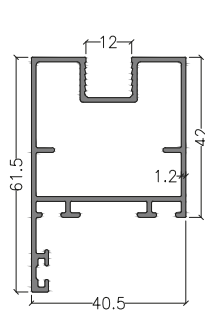

21408

0.798 kg/m "LW"
289.83 mm "AP"

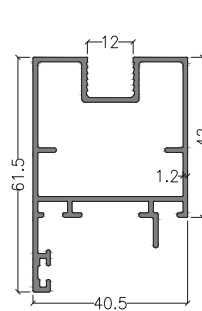

21409

0.824 kg/m "LW"
305.40 mm "AP"

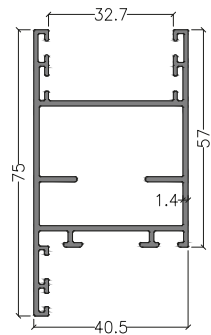

6957

1.006 kg/m "LW"
384.37 mm "AP"

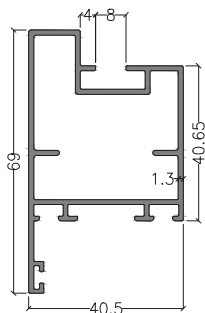

6261

0.893 kg/m "LW"
305.17 mm "AP"

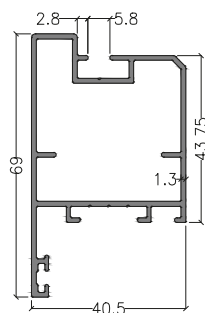

6960

0.848 kg/m "LW"
300.00 mm "AP"

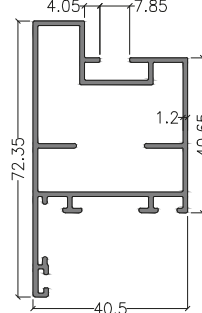

46901

0.875 kg/m "LW"
315.71 mm "AP"

Inner Frame Attachment

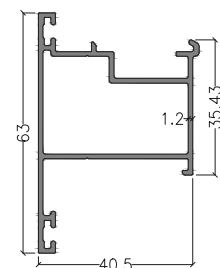

46903

0.694 kg/m "LW"
282.94 mm "AP"

ALBESASH PERFORMANCE CASEMENT WINDOW PCW02-40 SERIES

Accessories

Handles



CH100



CH720



CH200



CH600



CH708

Single Point



MPH3901
Single Fork



MPH3902
Single Fork



MPH3701
Double Fork



MPH3707
Double Fork

Altrax (Multipoint)



Flat Fork (32mm)



U-Fork (32mm)

Butt. Hinges



MP91



MP92HD Heavy Duty

Catches



MP930



MP930S

Corner Brackets



MP590A Alum.



MP90

Hinges

4 Bar Hinge
(13mm Stack Ht.)



CB12



CB04



CS12



Restrictor Bar



CR12

Lockcam



MP950
(10, 12, 14mm)

Latch Bolt & Keeper



MP962



MP960

Weather Strip



PLG5903
(Co-Extruded
Suntoprene - PP)



PLG6981
(Co-Extruded
Suntoprene - PP)

Push Rod



MP942



MP941KS



LB
ALUMINIUM
BERHAD
138535-V

HEAD OFFICE & FACTORY

Lot 11, Jalan Perusahaan 1, Kawasan Perusahaan Beranang,
43700 Beranang, Semenyih, Selangor Darul Ehsan, Malaysia.

Tel: +603-8725 8822 (Gen)

Email: enquiry@lbalum.com.my

Website: www.lbalum.com

Fax: +603-8725 8828 (Gen)

+603-8725 8866 (Export)



MS ISO 9001:2015 Cert. No. QMS 00216